

Motorreductores sinfín
corona con pre-reductor PU
**Motoredutores de rosca
sem fim com pré-estágio PU**
PU Pre-stage wormgearmotors

60HZ

IEC

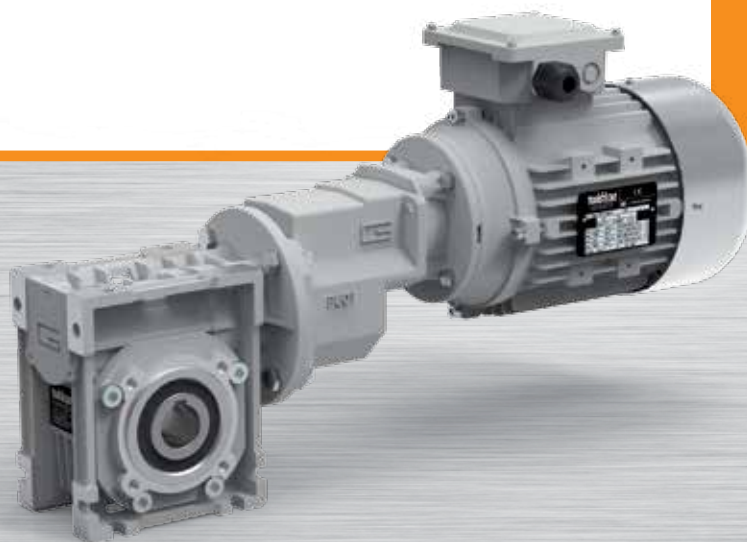

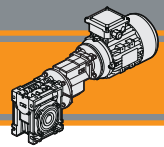

Índice	Índice	Index	Pag. Pág. Page
Características técnicas	<i>Características técnicas</i>	Technical features	L2
Clasificación	<i>Designação</i>	Classification	L2
Sentidos de rotación	<i>Sentidos de rotação</i>	Direction of rotation	L3
Nomenclatura	<i>Simbologia</i>	Symbols	L3
Lubricación	<i>Lubrificação</i>	Lubrication	L4
Cargas radiales	<i>Cargas radiais</i>	Radial loads	L4
<i>Motores aplicables</i>	Motores aplicáveis	IEC Motor adapters	L5
Datos técnicos	<i>Dados técnicos</i>	Technical data	L6
Dimensiones	<i>Dimensões</i>	Dimensions	L10
Accesorios	<i>Acessórios</i>	Accessories	L12
Opciones	<i>Opções</i>	Options	L12

Esta sección substituye y anula las ediciones y revisiones previas. Si usted obtiene este catálogo a través de canales de distribución no autorizados o fuera de nuestro control, la versión en vigor no estará garantizada. **En todo caso, la versión más actualizada está disponible en nuestra página de internet www.transtecno.com**

Esta seção anula e substitui qualquer edição ou revisão precedente. Caso esta seção não seja encontrada em distribuição controlada, a atualização dos dados aqui contidos não é segura. Neste caso a versão atualizada está disponível no nosso site: www.transtecno.com

This section replaces any previous edition and revision. If you obtained this catalogue other than through controlled distribution channels, the most up to date content is not guaranteed. **In this case the latest version is available on our web site www.transtecno.com**

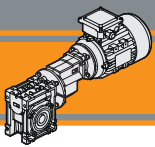

CMPU

Motorreductores sinfin corona con pre-reductor PU
 Motoredutores de rosca sem fim com pre-estágio PU
 PU Pre-stage wormgearmotors

60 Hz

Características técnicas

Características técnicas

Technical features

El alto grado de modularidad es una característica de diseño del motorreductor sinfin corona con pre-reductor CMPU las cuales varían con una amplia selección de kits de entrada y salida. Las principales características de gama CMPU son:

A alta modularidade distingue os motoredutores rosca sem fim da série CMPU: os diferentes kits de entrada e saída torná-los extremamente versátil. As principais características da série CMPU são:

The high degree of modularity is a design feature of CMPU wormgearmotors range thanks to a wide selection of input and output kits. Main features of CMPU range are:

- Carcasa de aluminio fundido a presión;
- O tamanho 090 é fornecido com rolamentos de rolos cônicos junto a rosca-sem fim;
- Lubrificação permanente com óleo sintético.
- Die cast aluminium housing;
- Double taper roller bearing on size 090;
- Permanent synthetic oil long life lubrication.

Clasificación

Designação

Classification

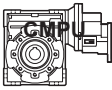
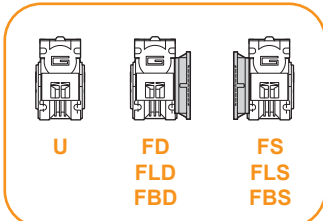
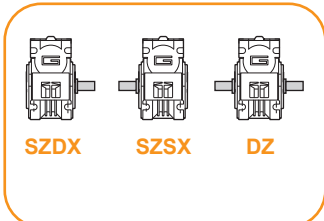
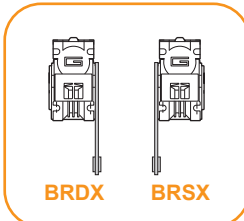
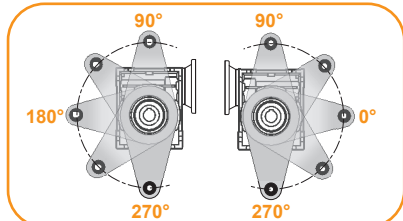
REDUCTOR / REDUTOR / GEARBOX											
CMPU	01/050	U	57	71	B14	SZDX	BRSX	90	P4	M1	VS
Tipo Type	Tamaño Size	Versión Version	Relación de reducción Rapporto Ratio	IEC	Forma constructiva Forma constructiva Version	∅ Eje de salida ∅ Eixo saída ∅ Output shaft	Brazo de reacción Braço de reação Torque arm	Ángulo Ângulo Angle	Pos. de montaje del pre-reductor Posição de montagem do pré-estágio Pre stage mounting position	Posición de montaje Pos. de montagem Mounting position	Opción Opções Options
	01/050 01/063 01/070 01/075 01/090	U FD FS FLD FLS FBD FBS	Vedere tabella See tables	63 71 80	B5 B14	SZDX SZSX DZ	BRDX BRSX	0° 90° 180° 270°	P1 P2 P3 (standard) P4	M1 (B3) M2 (V6) M3 (B8) M4 (V5) M6 (B6) M5 (B7)	VS
Versione Version Version		∅ Eje de salida ∅ Eixo saída ∅ Output shaft		Brazo de reacción Braço de reação Torque arm		Ángulo Ângulo Angle					
											

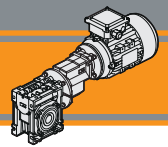

Clasificación

Designação

Classification

MOTOR / MOTOR / MOTOR					
0.75kW	4p	3ph	230/400V	50Hz	T1
Potencia <i>Potência</i> Power	Polos <i>Pólos</i> Poles	Fases <i>Fases</i> Phases	Tensión <i>Tensão</i> Voltage	Frecuencia <i>Frequência</i> Frequency	Posición caja de bornes <i>Pos. Conexão</i> Terminal box pos.
Veja tabelas <i>Véase tablas</i> see tables	2p 4p 6p 8p	1ph 3ph	230V 230/400V	50Hz 60Hz	T1 (Std) T4 T2 T3

Sentidos de rotación

Sentidos de rotação

Direction of rotation

CMPU

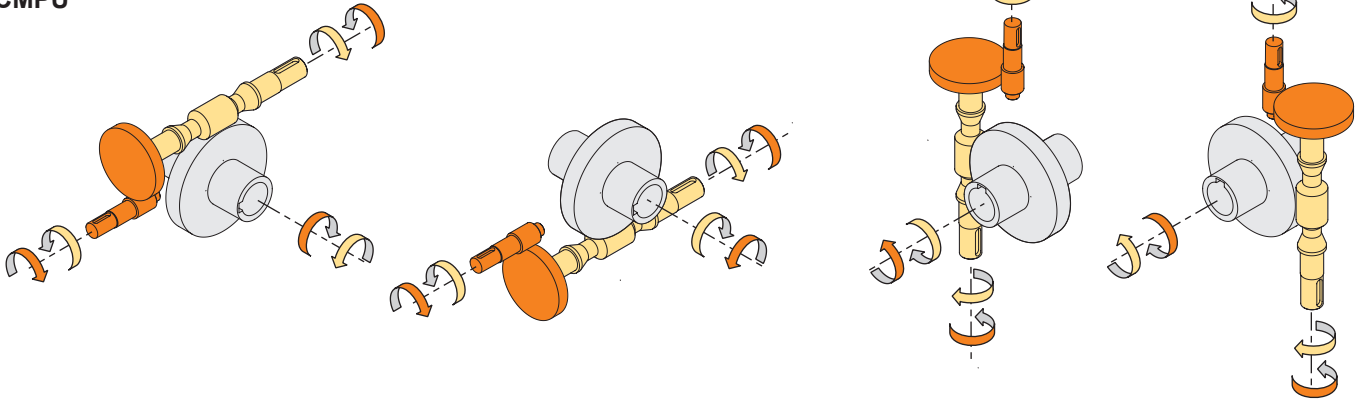

Nomenclatura

Simbologia

Legend

n_1	[rpm]	Velocidad de entrada / <i>Velocidade na entrada</i> / Input speed
n_2	[rpm]	Velocidad de salida / <i>Velocidade na saída</i> / Output speed
i		Relación de reducción / <i>Relação de redução</i> / Ratio
P_1	[kW]	Potencia en la entrada / <i>Potência da entrada</i> / Input power
M_2	[Nm]	Par en la salida en función de P_1 / <i>Torque na saída em função de P_1</i> / Output torque referred to P_1
sf		Factor de servicio / <i>Fator de serviço</i> / Service factor
R_2	[N]	Carga radial admisible en la salida / <i>Carga radial admissível na saída</i> / Maximum output radial load
A_2	[N]	Carga axial admisible en la salida / <i>Carga axial admissível na saída</i> / Maximum output axial load

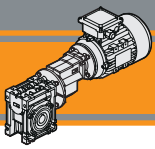

Lubricación

Lubrificação

Lubrication

Todos los motoredutores son previamente lubricados con aceite sintético con grado de viscosidad 320, por lo tanto, pueden ser instalados en cualquier posición de montaje y no requieren mantenimiento.

Todos os motoredutores são fornecidos completos de lubrificante sintético de viscosidade 320, portanto, podem ser instalados em qualquer posição de montagem e não necessitam de manutenção.

Permanent synthetic oil long-life lubrication (viscosity grade 320) makes it possible to use the gearmotors in all mounting positions; for this reason they can be installed in any assembly position and do not require maintenance.

Cargas radiales

Cargas radiais

Radial loads

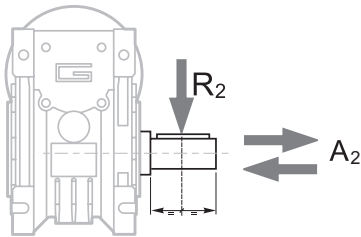

$$A_2 = R_2 \times 0.2$$

n ₂ [min ⁻¹]	R ₂ [N]				
	CMPU 01/050	CMPU 01/063	CMPU 01/070	CMPU 01/075	CMPU 01/090
47	2805	3874	4141	4475	5009
35	3095	4273	4568	4937	5526
28	3334	4603	4921	5318	5953
23	3559	4915	5254	5678	6356
18	3862	5334	5702	6162	6897
14	4200	5800	6200	6700	7500

Cuando la carga radial no se aplica en el punto medio del eje, es necesario calcular la carga efectiva a través la siguiente fórmula:

Quando a carga radial resultante não é aplicada na linha mediana da eixo, é preciso calcular aquela efetiva com a seguinte fórmula:

When the resulting radial load is not applied on the centre line of the shaft it is necessary to calculate the effective load with the following formula:

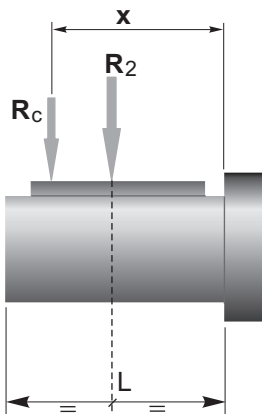

	CMPU				
	01/050	01/063	01/070	01/075	01/090
a	101	120	122	131	182
b	76	95	92	101	122
R _{2MAX}	4200	5800	6200	6700	7500

$$R_c = \frac{R_2 \cdot a}{(b + x)} \leq R_{2MAX}$$

$$R \leq R_c$$

a, b = valores dados en la tabla
 a, b = valores referidos na tabela
 a, b = values given in the table

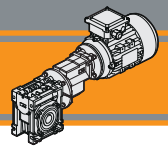

Motores Aplicables IEC

Motores aplicáveis

IEC Motor adapters

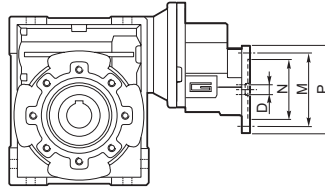

CMPU	IEC	N	M	P	D	i (i ₁ x i ₂)									
						28.5 (5,7x5)	42.75 (5,7x7,5)	57 (5,7x10)	64.28 (8,57x7,5)	85.5 (5,7x15)	85.7 (8,57x10)	114 (5,7x20)	128.55 (8,57x15)	142.5 (5,7x25)	171 (5,7x30)
01/050	63B5	95	115	140	11	BS	BS	BS	BS	BS	BS	BS	BS	BS	BS
	63B14	60	75	90		BS	BS	BS	BS	BS	BS	BS	BS	BS	BS
	71B5	110	130	160	14	B	B	B	B	B	B	B	B	B	B
	71B14	70	85	105		B	B	B	B	B	B	B	B	B	B
	80B5	130	165	200	19										
80B14	80	100	120												
01/063	63B5	95	115	140	11	BS	BS	BS	BS	BS	BS	BS	BS	BS	BS
	63B14	60	75	90		BS	BS	BS	BS	BS	BS	BS	BS	BS	BS
	71B5	110	130	160	14	B	B	B	B	B	B	B	B	B	B
	71B14	70	85	105		B	B	B	B	B	B	B	B	B	B
	80B5	130	165	200	19										
80B14	80	100	120												
01/070	63B5	95	115	140	11	-	BS	BS	BS	BS	BS	BS	BS	BS	BS
	63B14	60	75	90		-	BS	BS	BS	BS	BS	BS	BS	BS	BS
	71B5	110	130	160	14	-	B	B	B	B	B	B	B	B	B
	71B14	70	85	105		-	B	B	B	B	B	B	B	B	B
	80B5	130	165	200	19	-									
80B14	80	100	120	-											
01/075	63B5	95	115	140	11	-	BS	BS	BS	BS	BS	BS	BS	BS	BS
	63B14	60	75	90		-	BS	BS	BS	BS	BS	BS	BS	BS	BS
	71B5	110	130	160	14	-	B	B	B	B	B	B	B	B	B
	71B14	70	85	105		-	B	B	B	B	B	B	B	B	B
	80B5	130	165	200	19	-									
80B14	80	100	120	-											
01/090	63B5	95	115	140	11	-	BS	BS	BS	BS	BS	BS	BS	BS	BS
	63B14	60	75	90		-	BS	BS	BS	BS	BS	BS	BS	BS	BS
	71B5	110	130	160	14	-	B	B	B	B	B	B	B	B	B
	71B14	70	85	105		-	B	B	B	B	B	B	B	B	B
	80B5	130	165	200	19	-									
80B14	80	100	120	-											

CMPU	IEC	N	M	P	D	i (i ₁ x i ₂)									
						228 (5,7x40)	257.1 (8,57x30)	285 (5,7x50)	342.8 (8,57x40)	428.5 (8,57x50)	456 (5,7x80)	514.2 (8,57x60)	570 (5,7x100)	685.6 (8,57x80)	857 (8,57x100)
01/050	63B5	95	115	140	11		BS								
	63B14	60	75	90			BS								
	71B5	110	130	160	14		B								
	71B14	70	85	105			B								
	80B5	130	165	200	19										
80B14	80	100	120												
01/063	63B5	95	115	140	11	BS	BS	BS	BS	BS		BS			
	63B14	60	75	90		BS	BS	BS	BS	BS		BS			
	71B5	110	130	160	14	B	B	B	B	B		B			
	71B14	70	85	105		B	B	B	B	B		B			
	80B5	130	165	200	19										
80B14	80	100	120												
01/070	63B5	95	115	140	11	BS	BS	BS	BS	BS	BS	BS	BS	BS	
	63B14	60	75	90		BS	BS	BS	BS	BS	BS	BS	BS	BS	
	71B5	110	130	160	14	B	B	B	B	B	B	B	B	B	
	71B14	70	85	105		B	B	B	B	B	B	B	B	B	
	80B5	130	165	200	19										
80B14	80	100	120												
01/075	63B5	95	115	140	11	BS	BS	BS	BS	BS	BS	BS	BS	BS	
	63B14	60	75	90		BS	BS	BS	BS	BS	BS	BS	BS	BS	
	71B5	110	130	160	14	B	B	B	B	B	B	B	B	B	
	71B14	70	85	105		B	B	B	B	B	B	B	B	B	
	80B5	130	165	200	19										
80B14	80	100	120												
01/090	63B5	95	115	140	11	BS	BS	BS	BS	BS	BS	BS	BS	BS	
	63B14	60	75	90		BS	BS	BS	BS	BS	BS	BS	BS	BS	
	71B5	110	130	160	14	B	B	B	B	B	B	B	B	B	
	71B14	70	85	105		B	B	B	B	B	B	B	B	B	
	80B5	130	165	200	19										
80B14	80	100	120												

N.B. Las áreas grises indican los tamaño de los motores aplicables

N.B. As áreas evidenciadas em cinza indicam a aplicabilidade da correspondente grandeza do motor.

N.B. Grey areas indicate motor inputs available on each size of unit.

B/BS = Casquillo de reducción en acero

B/BS = Bucha de redução em aço

B/BS = Metal shaft sleeve



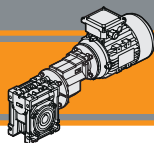

CMPU





Motorreductores sinfin corona con pre-reductor PU
 Motoredutores de rosca sem fim com pre-estagio PU
 PU Pre-stage wormgearmotors

60 Hz

Datos técnicos

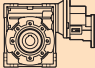
Dados técnicos

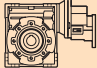
Technical data

P_1 [kW]	n_2 [min ⁻¹]	M_2 [Nm]	sf	i			P_1 [kW]	n_2 [min ⁻¹]	M_2 [Nm]	sf	i				
0.12						0.18									
(0.16 hp)	61	15	10.6	28.50	CMPU01/050	B5/B14	(0.25 hp)	15	75	1.8	114.00	CMPU01/063	B5/B14		
	41	22	7.2	42.75			B5/B14		14	89	1.8			128.55	B5/B14
63A4	31	28	5.6	57.00			B5/B14	63B4	12	88	1.4			142.50	B5/B14
(1750 min ⁻¹)	27	33	4.8	64.28			B5/B14	(1750 min ⁻¹)	10	95	1.7			171.00	B5/B14
	20	40	4.1	85.50			B5/B14		8.2	132	0.9			214.25	B5/B14
	20	42	3.7	85.70			B5/B14		6.8	144	1.1			257.10	B5/B14
	15	50	2.8	114.00			B5/B14								
	14	59	2.7	128.55			B5/B14		15	74	3.5			114.00	B5/B14
	12	59	2.1	142.50			B5/B14		14	88	3.4			128.55	B5/B14
	10	64	2.5	171.00			B5/B14		12	86	2.6			142.50	B5/B14
	8.2	88	1.4	214.25	B5/B14		10	99	3.1	171.00	B5/B14				
	6.8	96	1.7	257.10	B5/B14		8.2	130	1.8	214.25	B5/B14				
					CMPU01/063	B5/B14		7.7	119	2.2	228.00	B5/B14			
	14	59	5.2	128.55			B5/B14		6.8	148	2.1	257.10	B5/B14		
	12	58	4.0	142.50			B5/B14		6.1	137	1.7	285.00	B5/B14		
	10	66	4.7	171.00			B5/B14		5.1	178	1.5	342.80	B5/B14		
	8.2	87	2.6	214.25			B5/B14		4.1	206	1.1	428.50	B5/B14		
	7.7	79	3.3	228.00			B5/B14		3.4	228	0.9	514.20	B5/B14		
	6.8	99	3.1	257.10			B5/B14								
	6.1	91	2.5	285.00			B5/B14		8.2	134	2.5	214.25	B5/B14		
	5.1	119	2.2	342.80			B5/B14		7.7	119	3.2	228.00	B5/B14		
	4.1	137	1.7	428.50			B5/B14		6.8	148	3.1	257.10	B5/B14		
	3.4	152	1.4	514.20	B5/B14		6.1	137	2.4	285.00	B5/B14				
					CMPU01/070	B5/B14		5.1	178	2.1	342.80	B5/B14			
	6.1	91	3.7	285.00			B5/B14		4.1	206	1.6	428.50	B5/B14		
	5.1	119	3.2	342.80			B5/B14		3.8	176	1.6	456.00	B5/B14		
	4.1	137	2.4	428.50			B5/B14		3.4	228	1.4	514.20	B5/B14		
	3.8	117	2.3	456.00			B5/B14		3.1	198	1.2	570.00	B5/B14		
	3.4	152	2.1	514.20			B5/B14		2.6	264	1.0	685.60	B5/B14		
	3.1	132	1.8	570.00			B5/B14								
	2.6	176	1.6	685.60			B5/B14		5.1	181	2.6	342.80	B5/B14		
	2.0	198	1.2	857.00			B5/B14		4.1	206	2.0	428.50	B5/B14		
							CMPU01/075	B5/B14		3.8	176	1.9	456.00	B5/B14	
	3.8	117	2.8	456.00	B5/B14				3.4	233	1.6	514.20	B5/B14		
	3.4	155	2.4	514.20	B5/B14				3.1	198	1.5	570.00	B5/B14		
	3.1	132	2.2	570.00	B5/B14				2.6	264	1.2	685.60	B5/B14		
	2.6	176	1.9	685.60	B5/B14				2.0	297	1.0	857.00	B5/B14		
	2.0	198	1.5	857.00	B5/B14										
					CMPU01/090	B5/B14				4.1	223	3.1	428.50	B5/B14	
	3.4	168	3.7	514.20					B5/B14		3.8	193	2.8	456.00	B5/B14
	3.1	143	3.4	570.00					B5/B14		3.4	252	2.5	514.20	B5/B14
	2.6	194	2.8	685.60					B5/B14		3.1	214	2.2	570.00	B5/B14
	2.0	214	2.2	857.00			B5/B14		2.6	290	1.8	685.60	B5/B14		
									2.0	322	1.5	857.00	B5/B14		

0.18

(0.25 hp)	61	22	7.1	28.50	CMPU01/050	B5/B14	
	41	33	4.8	42.75			B5/B14
63B4	31	42	3.7	57.00			B5/B14
(1750 min ⁻¹)	27	49	3.2	64.28			B5/B14
	20	59	2.7	85.50			B5/B14
	20	63	2.5	85.70	B5/B14		

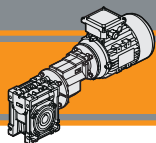

CMPU





Motorreductores sin fin corona con pre-reductor PU
 Motoredutores de rosca sem fim com pre-estágio PU
 PU Pre-stage wormgearmotors

60 Hz

Datos técnicos

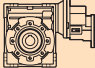
Dados técnicos

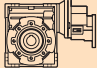
Technical data

P ₁ [kW]	n ₂ [min ⁻¹]	M ₂ [Nm]	sf	i			P ₁ [kW]	n ₂ [min ⁻¹]	M ₂ [Nm]	sf	i				
0.37							0.55								
(0.50 hp)	8.2	293	2.4	214.25	CMPU01/090	B5/B14	(0.75 hp)	14	284	1.6	128.55	CMPU01/090	B5/B14		
	7.7	262	3.1	228.00			B5/B14		12	289	2.5			142.50	B5/B14
71A4	6.8	321	2.4	257.10			B5/B14	71B4	10	317	3.0			171.00	B5/B14
(1750 min ⁻¹)	6.1	305	2.3	285.00			B5/B14	(1750 min ⁻¹)	8.2	435	1.6			214.25	B5/B14
	5.1	393	2.1	342.80			B5/B14		7.7	389	2.1			228.00	B5/B14
	4.1	458	1.5	428.50			B5/B14		6.8	476	1.6			257.10	B5/B14
	3.8	397	1.3	456.00			B5/B14		6.1	453	1.5			285.00	B5/B14
	3.4	519	1.2	514.20			B5/B14		5.1	585	1.4			342.80	B5/B14
	3.1	440	1.1	570.00			B5/B14		4.1	681	1.0			428.50	B5/B14
	2.6	597	0.9	685.60			B5/B14		3.8	590	0.9			456.00	B5/B14



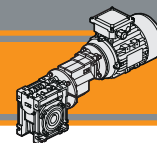

0.55							0.75								
(0.75 hp)	61	67	2.3	28.50	CMPU01/050	B5/B14	(1.0 hp)	61	91	1.7	28.50	CMPU01/050	B5/B14		
	41	99	1.6	42.75			B5/B14		41	135	1.2			42.75	B5/B14
71B4	31	127	1.2	57.00			B5/B14	80A4	31	174	0.9			57.00	B5/B14
(1750 min ⁻¹)	27	149	1.0	64.28			B5/B14	(1750 min ⁻¹)							
	20	181	0.9	85.50			B5/B14		61	93	2.2			28.50	CMPU01/063
	61	68	3.0	28.50	CMPU01/063	B5/B14		41	137	2.1	42.75	B5/B14			
	41	101	2.9	42.75			B5/B14		31	176	1.6	57.00	B5/B14		
	31	129	2.2	57.00			B5/B14		27	206	1.2	64.28	B5/B14		
	27	151	1.6	64.28			B5/B14		20	243	1.2	85.50	B5/B14		
	20	179	1.7	85.50			B5/B14		20	265	1.1	85.70	B5/B14		
	20	194	1.5	85.70			B5/B14		41	139	2.2	42.75	CMPU01/070	B5/B14	
	15	225	1.2	114.00			B5/B14		31	178	2.2	57.00		B5/B14	
	14	268	1.1	128.55			B5/B14		27	209	1.2	64.28		B5/B14	
	12	264	0.9	142.50			B5/B14		20	247	1.8	85.50		B5/B14	
	10	302	1.0	171.00			B5/B14		20	268	1.2	85.70		B5/B14	
	20	181	2.4	85.50	CMPU01/070	B5/B14		15	311	1.3	114.00	B5/B14			
	20	197	1.6	85.70			B5/B14		14	371	1.2	128.55		B5/B14	
	15	228	1.7	114.00			B5/B14		12	372	0.9	142.50		B5/B14	
	14	272	1.6	128.55			B5/B14		10	412	1.1	171.00		B5/B14	
	12	272	1.3	142.50			B5/B14		27	209	1.2	64.28		CMPU01/075	B5/B14
	10	302	1.5	171.00			B5/B14		20	250	2.1	85.50	B5/B14		
	7.7	362	1.0	228.00			B5/B14		20	268	1.2	85.70	B5/B14		
	6.8	454	1.0	257.10			B5/B14		15	316	1.5	114.00	B5/B14		
	20	197	1.6	85.70			CMPU01/075	B5/B14		14	376	1.2	128.55		B5/B14
	15	231	2.0	114.00					B5/B14		12	372	1.1		142.50
	14	276	1.9	128.55	B5/B14				10	412	1.3	171.00	B5/B14		
	12	272	1.5	142.50	B5/B14				7.7	503	0.9	228.00	B5/B14		
	10	302	1.8	171.00	B5/B14				6.8	619	0.9	257.10	B5/B14		
	8.2	410	1.0	214.25	B5/B14										
	7.7	369	1.3	228.00	B5/B14										
	6.8	454	1.2	257.10	B5/B14										
	6.1	419	1.0	285.00	B5/B14										

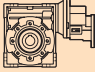

Datos técnicos

Dados técnicos

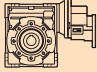
Technical data

P_1 [kW]	n_2 [min ⁻¹]	M_2 [Nm]	sf	i			P_1 [kW]	n_2 [min ⁻¹]	M_2 [Nm]	sf	i					
0.75							1.1									
(1.0 hp)	20	257	3.4	85.50	CMPU01/090	B5/B14	(1.5 hp)	41	209	1.5	42.75	CMPU01/090	B5/B14			
	20	278	1.2	85.70			B5/B14		31	272	1.5			57.00	B5/B14	
80A4	15	329	2.2	114.00			B5/B14		80B4	20	377			1.5	85.50	B5/B14
(1750 min ⁻¹)	14	387	1.2	128.55			B5/B14		(1750 min ⁻¹)	15	483			1.5	114.00	B5/B14
	12	394	1.8	142.50			B5/B14			12	578			1.2	142.50	B5/B14
	10	432	2.2	171.00			B5/B14			10	634			1.5	171.00	B5/B14
	8.2	593	1.2	214.25			B5/B14			7.7	778			1.0	228.00	B5/B14
	7.7	530	1.5	228.00			B5/B14									
	6.8	650	1.2	257.10			B5/B14									
	6.1	617	1.1	285.00			B5/B14									
	5.1	797	1.0	342.80	B5/B14											

1.1

(1.5 hp)	61	134	1.2	28.50	CMPU01/050	B5/B14
80B4	61	136	1.5	28.50	CMPU01/063	B5/B14
(1750 min ⁻¹)	41	201	1.5	42.75		B5/B14
	31	258	1.1	57.00		B5/B14
	27	302	1.0	64.28		B5/B14
	41	204	1.5	42.75	CMPU01/070	B5/B14
	31	262	1.5	57.00		B5/B14
	20	362	1.2	85.50		B5/B14
	15	456	0.9	114.00		B5/B14
	41	204	1.5	42.75	CMPU01/075	B5/B14
	31	262	1.5	57.00		B5/B14
	20	367	1.4	85.50		B5/B14
	15	463	1.0	114.00		B5/B14
	10	604	0.9	171.00		B5/B14

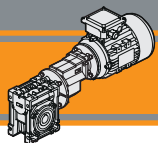

CMPU

Motorreductores sin fin corona con pre-reductor PU
 Motoredutores de rosca sem fim com pre-estagio PU
 PU Pre-stage wormgearmotors

60 Hz

Dimensiones

Dimensões

Dimensions

CMPU.. - CMPU..F - CMPU..FB - CMPU..FL														
	A	C	D _{H8}	E	F	G1	H	HX	I	K	L	M	N _{H8}	N1
01/050	80	120	25	144	49	92	60	36.5	50	70	85	85	70	43.5
01/063	100	144	25	174	67	112	72	36.5	63	85	104	95	80	53
01/070	110	160	28	195	64	120	80	36.5	70	90	104	115	95	57
01/075	120	172	28	205	72	120	86	36.5	75	90	112	115	95	57
01/090	140	208	35	238	74	140	103	36.5	90	100	130	130	110	67

CMPU.. - CMPU..F - CMPU..FB - CMPU..FL													
	O	P	Q	R	S	T	V	Z	KE	a	b	t	Kg
01/050	8.5	98	64	84	7	30	40	210	M8x10(n.4)	45°	8	28.3 (27.3)	6.0
01/063	8.5	110	80	102	8	36	50	228	M8x14(n.8)	45°	8	28.3	8.7
01/070	9	130	91	115	9	40	55	238	M8x14(n.8)	45°	8	31.3	10.0
01/075	11	140	93	119	10	40	60	243	M8x14(n.8)	45°	8	31.3	11.5
01/090	13	160	102	135	11	45	70	260	M10x18(n.8)	45°	10	38.3	15.5

	CMPU..F								CMPU..FB								CMPU..FL							
	a1	KA	KB	KC	KM	KN _{H8}	KO	KP	KQ	KA	KB	KC	KM	KN _{H8}	KO	KP	KA	KB	KC	KM	KN _{H8}	KO	KP	KQ
01/050	45°	90	9	5	90-110	70	11(n.4)	125	110	89	9	5	130-145	110	9.5(n.4)	160	120	9	5	90-110	70	11(n.4)	125	110
01/063	45°	82	10	6	150-160	115	11(n.4)	180	142	98	10	5	165-180	130	11(n.4)	200	112	10	6	150-160	115	11(n.4)	180	142
01/070	45°	111	13	6	165-180	130	14(n.4)	200	170	—	—	—	—	—	—	—	—	—	—	—	—	—	—	—
01/075	45°	111	13	6	165-180	130	14(n.4)	200	170	—	—	—	—	—	—	—	—	—	—	—	—	—	—	—
01/090	45°	111	13	6	175-190	152	14(n.4)	210	200	—	—	—	—	—	—	—	—	—	—	—	—	—	—	—

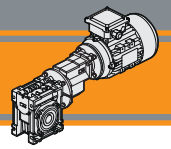

Dimensiones

Dimensões

Dimensions

CMPU..U

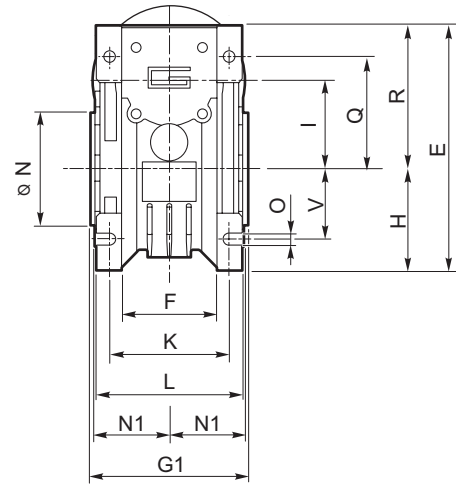
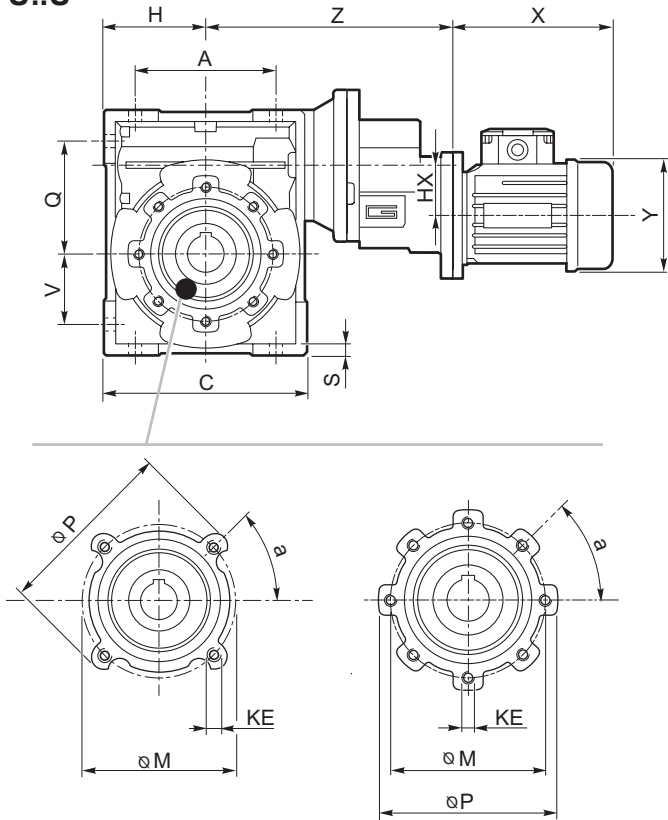

..01/050

..01/063
 ..01/070
 ..01/075
 ..01/090

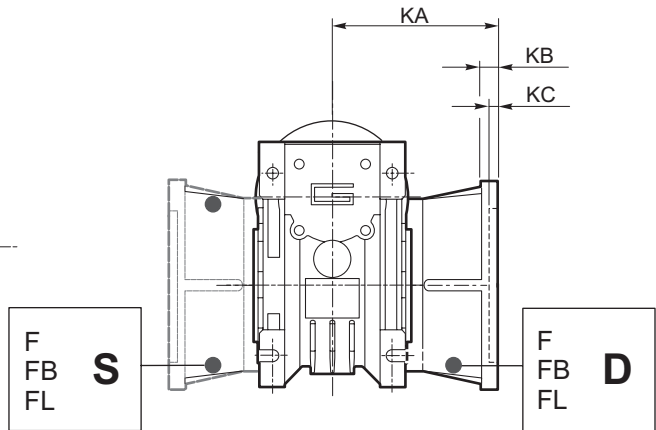
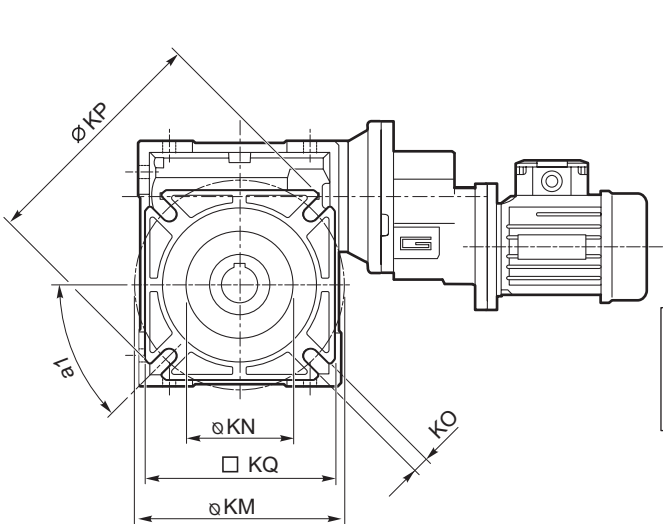

CMPU..F (..01/050 - .. 01/090)
CMPU..FB (.. 01/050 - .. 01/063)
CMPU..FL (.. 01/050 - .. 01/063)

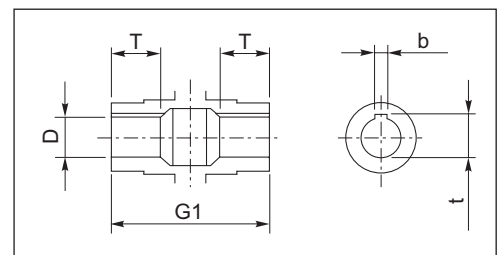

Eje de salida hueco
 Eixo saída vazado
 Hollow output shaft

CMPU

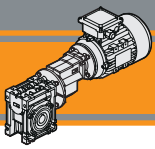

CMPU

Motorreductores sin fin corona con pre-reductor PU
 Motoredutores de rosca sem fim com pre-estagio PU
 PU Pre-stage wormgearmotors

60 Hz

Accesorios

Acessórios

Accessories

Eje de salida simple y doble

Eixo lenta simples e dupla

Single and double output shaft

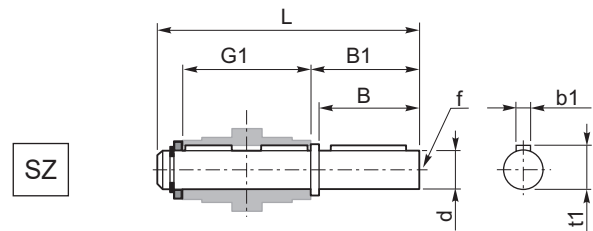
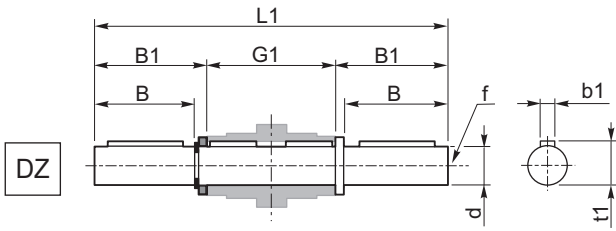

CMPU	d _{h7}	B	B1	G1	L	L1	f	b1	t1
01/050	25	50	53.5	92	153	199	M10	8	28
01/063	25	50	53.5	112	173	219	M10	8	28
01/070	28	60	63.5	120	192	247	M10	8	31
01/075	28	60	63.5	120	192	247	M10	8	31
01/090	35	80	84.5	140	234	309	M12	10	38

Brazo de reacción

Braço de reação

Torque arm

CMPU	K1	G	KG	KH	R
01/050	100	14	38	10	18
01/063	150	14	47.5	10	18
01/070	200	25	46.5	20	30
01/075	200	25	46.5	20	30
01/090	200	25	56.5	20	30

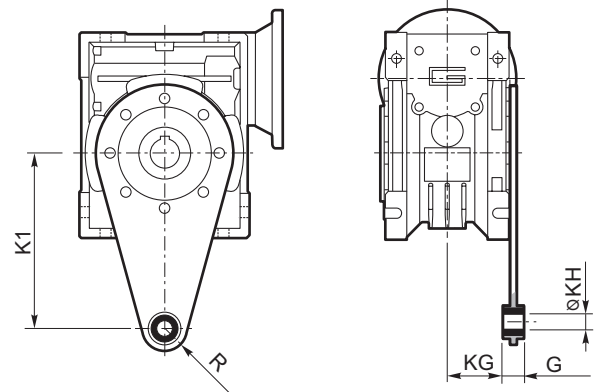

SC - Cubierta de seguridad / Tampa de proteção / Safety cover

CMPU	M
01/050	62.5
01/063	73
01/070	75
01/075	79
01/090	94

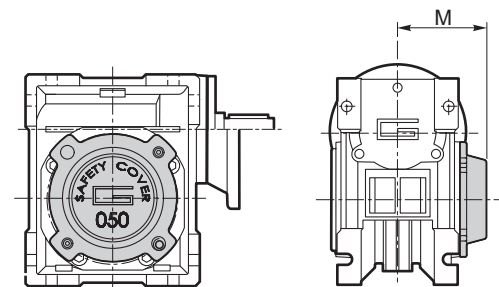

Opciones

Opções

Options

VS - Tornillo sin fin sobresaliente / Parafuso saliente / Extended input shaft

CMPU	A	B	D ₁ _{j6}	E	F	G
01/050	64	30	14	M6	5	16
01/063	75	40	19	M6	6	21.5
01/070	84	40	19	M6	6	21.5
01/075	90	50	24	M8	8	27
01/090	108	50	24	M8	8	27

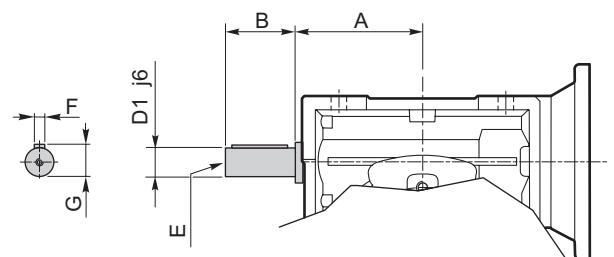

Construido bajo pedido / Fabricado sob encomenda / Built on request



TRANSTECNO SRL HEADQUARTERS

Company subject to the management
and coordination of INTERPUMP GROUP SPA
Via Caduti di Sabbiano, 11/D-E
40011 Anzola dell'Emilia (BO)
ITALY
T+39 051 64 25 811
F +39 051 73 49 43
sales@transtecno.com
www.transtecno.com



**HANGZHOU TRANSTECNO POWER
TRANSMISSIONS CO LTD**
No.4 Xiuyan Road Fengdu Industry Zone
Pingyao Town Yuhang District
Hangzhou City, Zhejiang Province
311115 – CHINA
T +86 571 86 92 02 60
F +86 571 86 92 18 10
info-china@transtecno.cn
www.transtecno.cn



MA TRANSTECNO S.A.P.I. DE C.V.
Av. Mundial # 176, Parque Industrial
JM Apodaca, Nuevo León,
C.P. 66600 – MÉXICO
T +52 8113340920
info@transtecno.com.mx
www.transtecno.com.mx



**TRANSTECNO IBÉRICA
THE MODULAR GEARMOTOR, S.A.**
Carrer de la Ciència, 45
08840 Viladecans (Barcelona) – SPAIN
T +34 931 598 950
info@transtecno.es
www.transtecno.es



TRANSTECNO B.V.
Siliciumweg 32
3812 SX Amersfoort – NETHERLANDS
T +31(0) 33 45 19 505
F +31(0) 33 45 19 506
info@transtecno.nl
www.transtecno.nl

www.transtecno.com



TRANSTECNO AANDRIJFTECHNIEK B.V.
Siliciumweg 32
3812 SX Amersfoort – NETHERLANDS
T +31 (0) 33 20 47 006
info@transtecnoandrijftechnik.nl
www.transtecnoandrijftechnik.nl



TRANSTECNO USA
8 Creek Parkway,
Boothwyn PA 19061-8136 - UNITED STATES
T + 1 (610) 4970154
F +1 (610) 497 6085

TRANSTECNO USA – WEST COAST BRANCH
14561 Fryelands Blvd SE
Monroe, WA 98272 – UNITED STATES
T +1 360-863-1300
F +1 360-863-1303
usaoffice@transtecno.com
www.transtecno.com



TRANSTECNO CANADA
51 B Caldari Road Unit 10
Vaughan, ON L4K 4G3 - CANADA
T +1 905 761 0762
F +1 905 761 9265
canadaoffice@transtecno.com
www.transtecno.com



TRANSTECNO CHILE-PERU
Av. Los Libertadores 41
Parque Industrial - Los Libertadores 16.500
Santiago, Colina - CHILE
T +56 2 29633870

Carretera Panamericana Sur KM 29.5,
Interior I-3, Z.I. Lurin - PERU
T +51 1 3546259 / +51 1 3434231
chileoffice@transtecno.com
www.transtecno.com



TRANSTECNO INDIA
#6A, Sipcot Industrial complex, Phase-1, Elasagiri Road
Hosur – 635126 Tamilnadu - INDIA
T +91 4344 274434
M +91 81443 88800

TRANSTECNO INDIA – NORTH BRANCH
Plot No: 3 A, Sector 2, IIE, Sidcul, Pantnagar
U.S. Nagar, Uttarakhand – 263153 - INDIA
indiaoffice@transtecno.com
www.transtecno.com



SALES OFFICE BRAZIL
Rua Dr. Freire Alemão 155 / 402 - CEP. 90450-060
Auxiliadora Porto Alegre RS - BRAZIL
T +55 51 3251 5447
F +55 51 3251 5447
M +55 51 811 45 962
braziloffice@transtecno.com
www.transtecno.com.br



SALES OFFICE OCEANIA
Unit 5, 12 Nyholt Drive, Yatala 4207
Queensland - AUSTRALIA
T +61 07 3800 0103
M +61 04 38060997
oceaniaoffice@transtecno.com
www.transtecno.com.au



SALES OFFICE SOUTH KOREA
772-41, Bongdong-ro, Bongdong-eup, Wanju-goon
Chonbuk, 55313
SOUTH KOREA
T +82 70 8867 8897
F +82 504 199 2107
M +82 10 5094 2107
koreaoffice@transtecno.com
www.transtecno.com